

FIXED BARRIER SHOWN

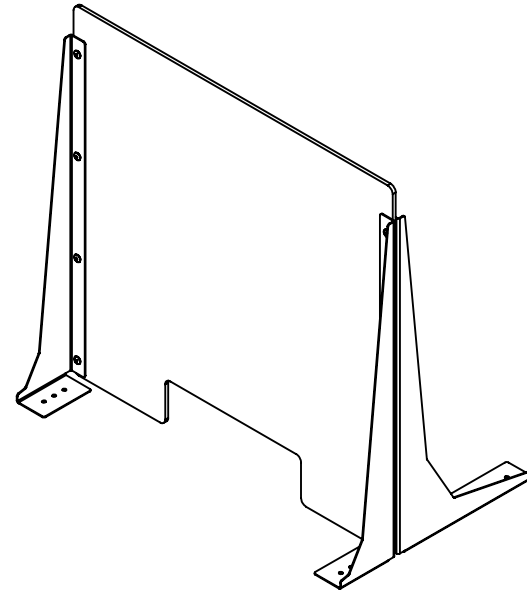

FREE STANDING BARRIER SHOWN

SURFACE OR COUNTER MOUNTING:

- 1. FIXED BARRIER (SEE SHEET 2):**
VHB TAPE, ACRYLIC ADHESIVE (SUPPLIED) -OR-
#10 SCREW, QTY: 4 (NOT SUPPLIED).
- 2. FREE STANDING BARRIER (SEE SHEET 3):**
LEFT AND RIGHT LEG MOUNTED ON CUSTOMER SIDE (SUPPLIED).
NOTE THAT THIS REQUIRES 4" MIN CLEARANCE ON CUSTOMER SIDE.
ASSEMBLY REQUIRED.
- 3.** APPROXIMATE WEIGHT:
8.22 lbs. FIXED BARRIER
- 4.** 10.31 lbs. FREE STANDING BARRIER

KENDALL HOWARD CONFIDENTIAL THE INFORMATION CONTAINED IN THIS DRAWING IS THE SOLE PROPERTY OF KENDALL HOWARD. ANY REPRODUCTION IN PART OR AS A WHOLE WITHOUT THE WRITTEN PERMISSION OF KENDALL HOWARD IS STRICTLY PROHIBITED.					UNLESS OTHERWISE SPECIFIED, ALL DIMENSIONS ARE IN INCHES.		APPROVAL		DATE		KENDALL HOWARD TITLE: PRODUCT DATA- 24X24 BARRIER		
					TOLERANCES: FRACTIONAL: $\pm 1/8$ ANGULAR: $\pm 1^\circ$ TWO PLACE DECIMAL: $\pm .03$ THREE PLACE DECIMAL: $\pm .010$ HOLE: $\pm .005$		DRAWN BS 05/06/2020 DESIGN RH 05/07/2020 ENG APPR MFG APPR		LEGACY Part Number:				
					MATERIAL: NA SURFACE AREA (in²): NA FINISH ID: NA FINISH DESCRIPTION: NA		CLASSIFICATION: Product Data		SCALE: 1:10				
					DO NOT SCALE DRAWING		THIRD ANGLE PROJECTION 		INTERPRET DIMENSIONS AND TOLERANCES PER ASME Y14.5-2009				
MANUFACTURING COMMENTS: Product data											DWG. NO. SB-AC-24X24		REV 01
ECO No: Description: By: Date: App By:											WEIGHT (lbs): 8.22		SHEET 1 OF 3

FIXED BARRIER SHOWN

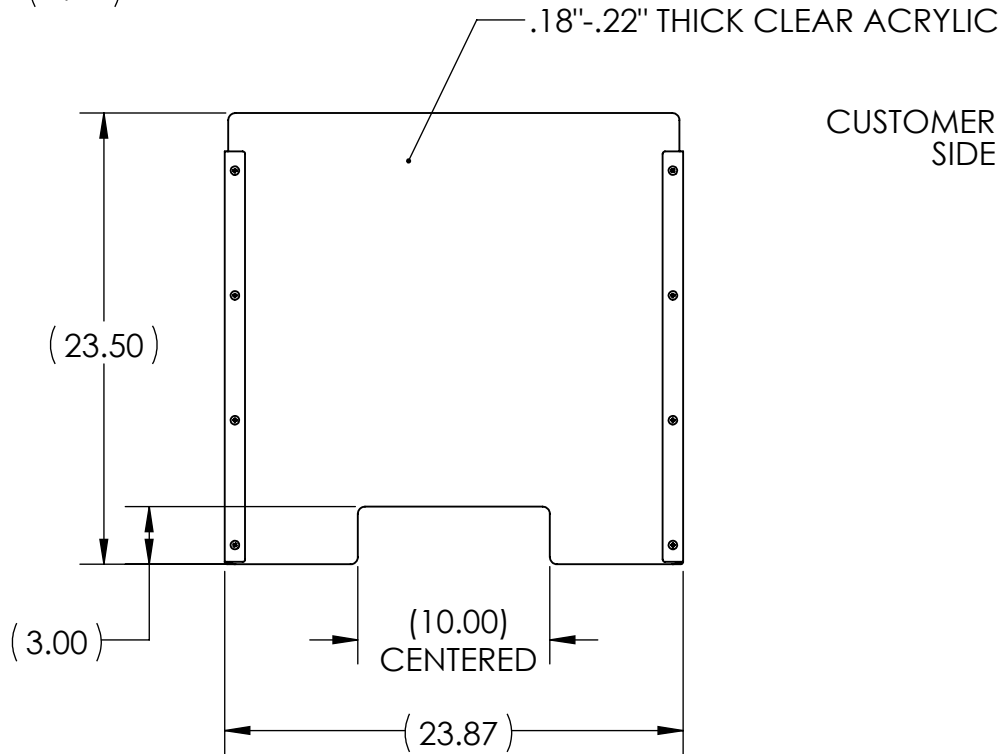
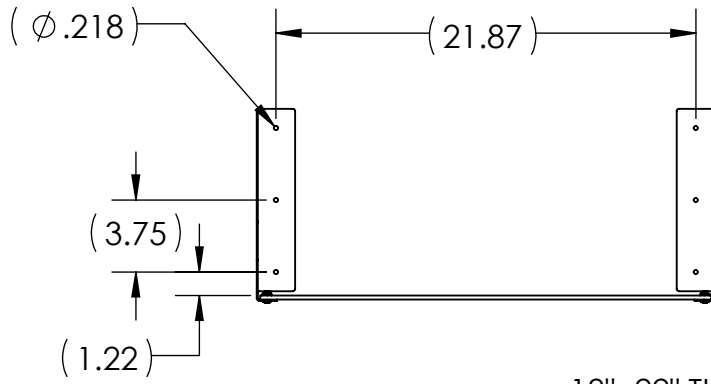

CUSTOMER
SIDE

EMPLOYEE
SIDE

16GA STEEL LEGS
POWDER COAT, BLACK

(10.00)

KENDALL HOWARD		
SIZE A	DWG. NO. SB-AC-24X24	REV 01
PRODUCT DATA		
SCALE: 1:10	WEIGHT (lbs): 8.22	SHEET 2 OF 3

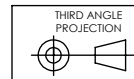

INTERPRET DIMENSIONS
AND TOLERANCES PER
ASME Y14.5-2009

FREE STANDING BARRIER SHOWN

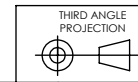
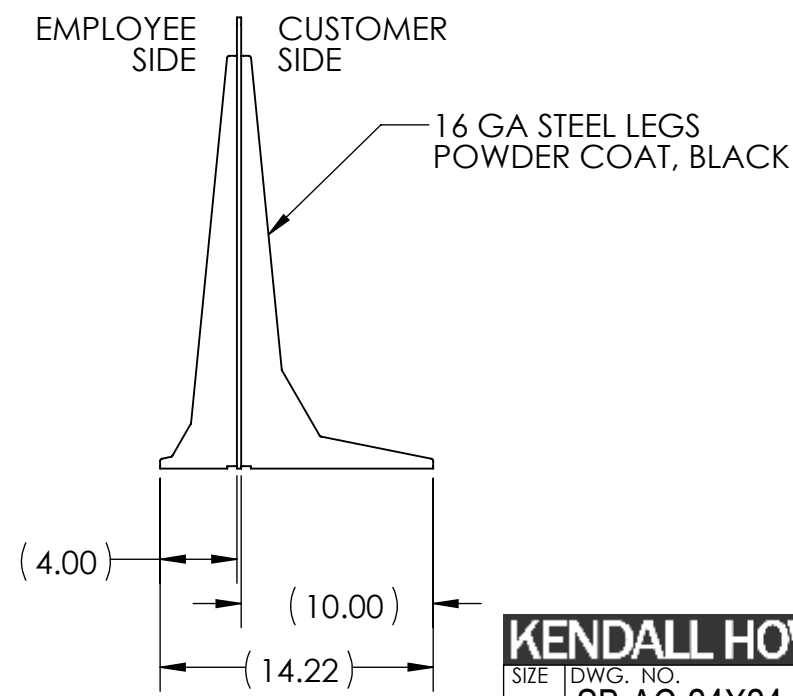
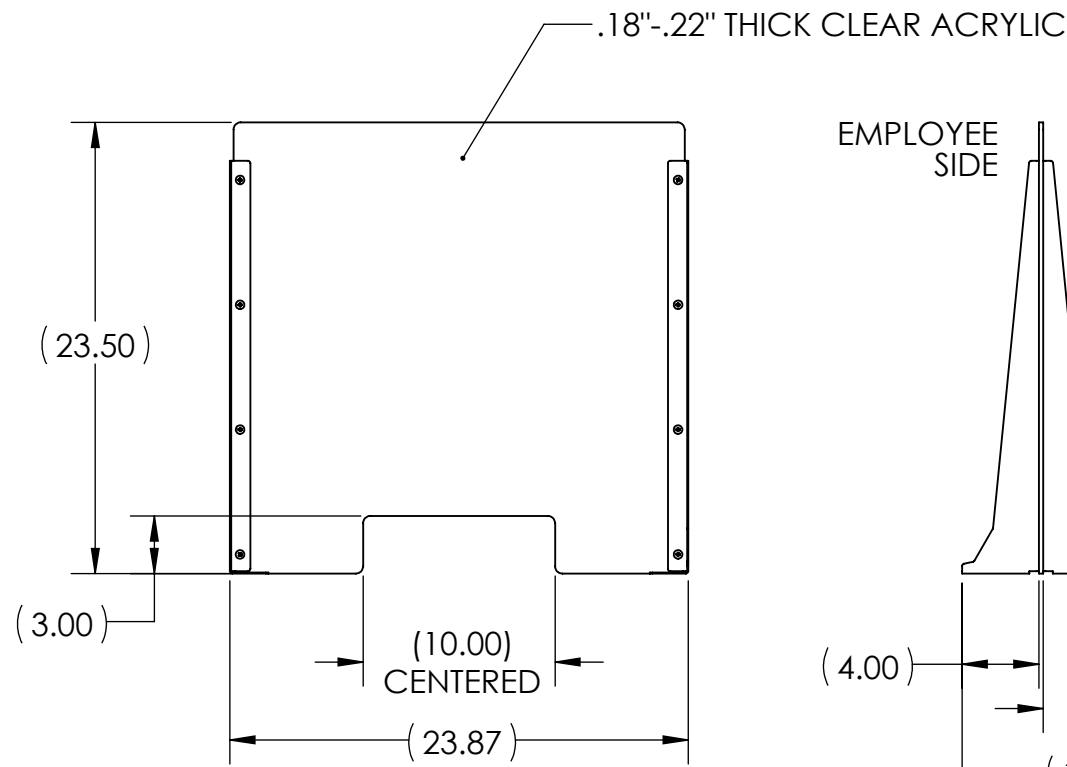
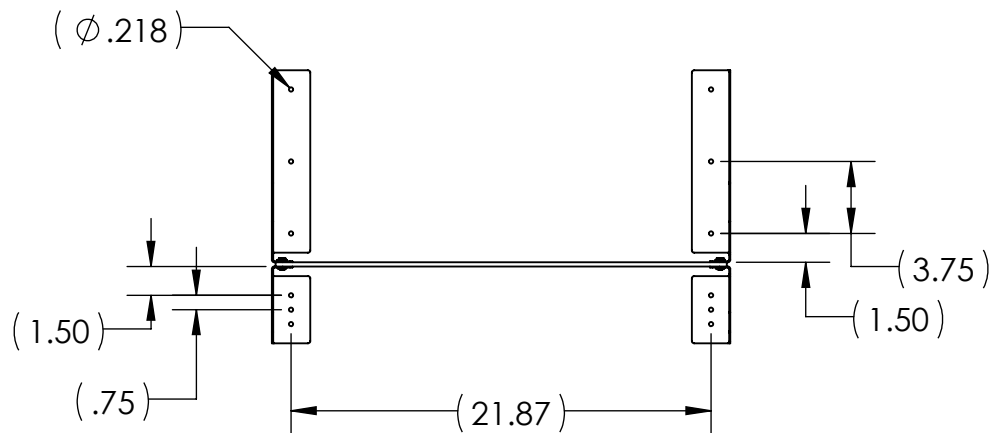

INTERPRET DIMENSIONS AND TOLERANCES PER ASME Y14.5-2009

KENDALL HOWARD		
SIZE	DWG. NO.	REV
A	SB-AC-24X24	01
PRODUCT DATA		
SCALE: 1:10	WEIGHT (lbs): 8.22	SHEET 3 OF 3